

PARTICOLARE 16 scala 1:10

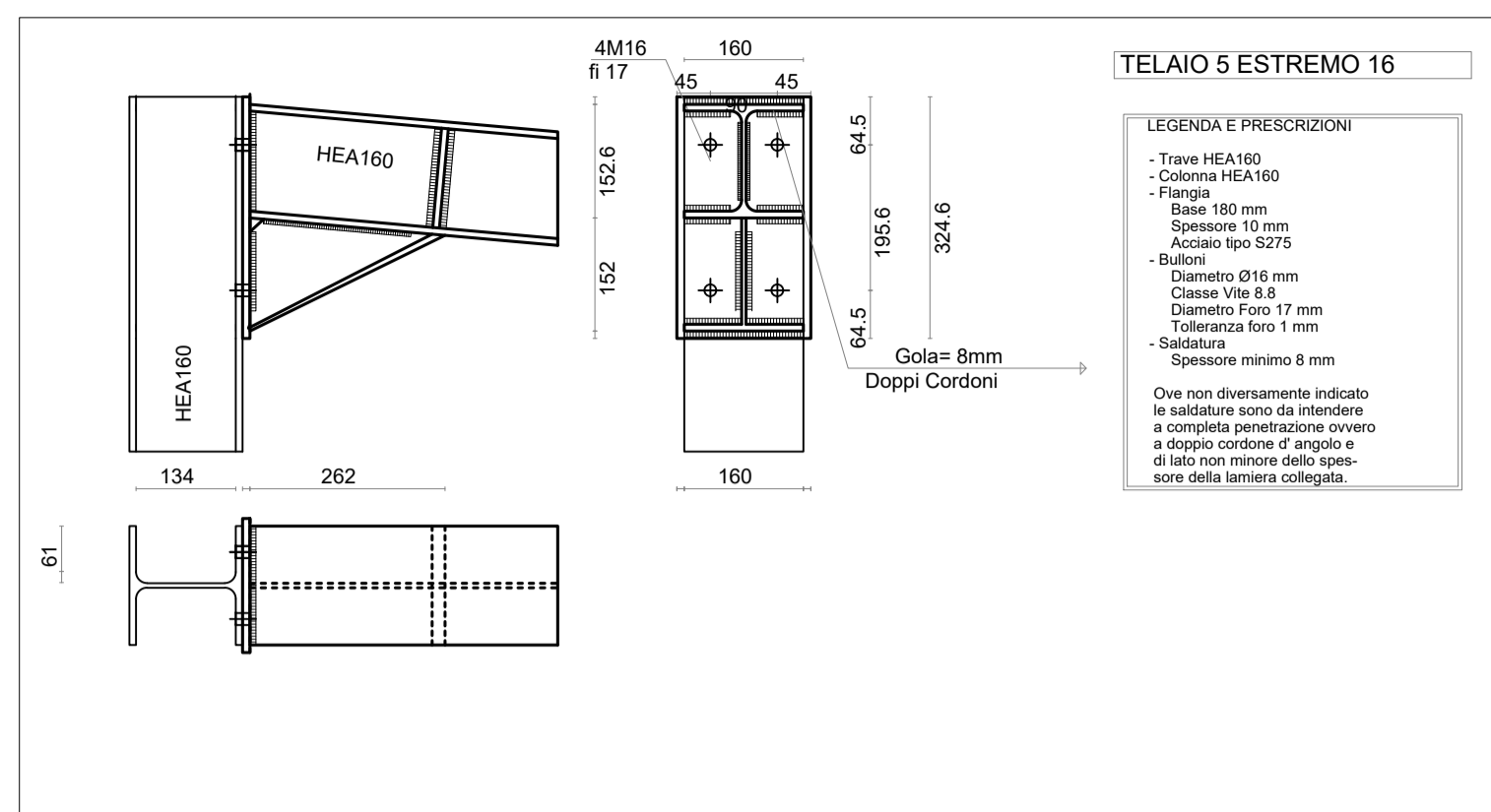

PARTICOLARE 17 scala 1:10

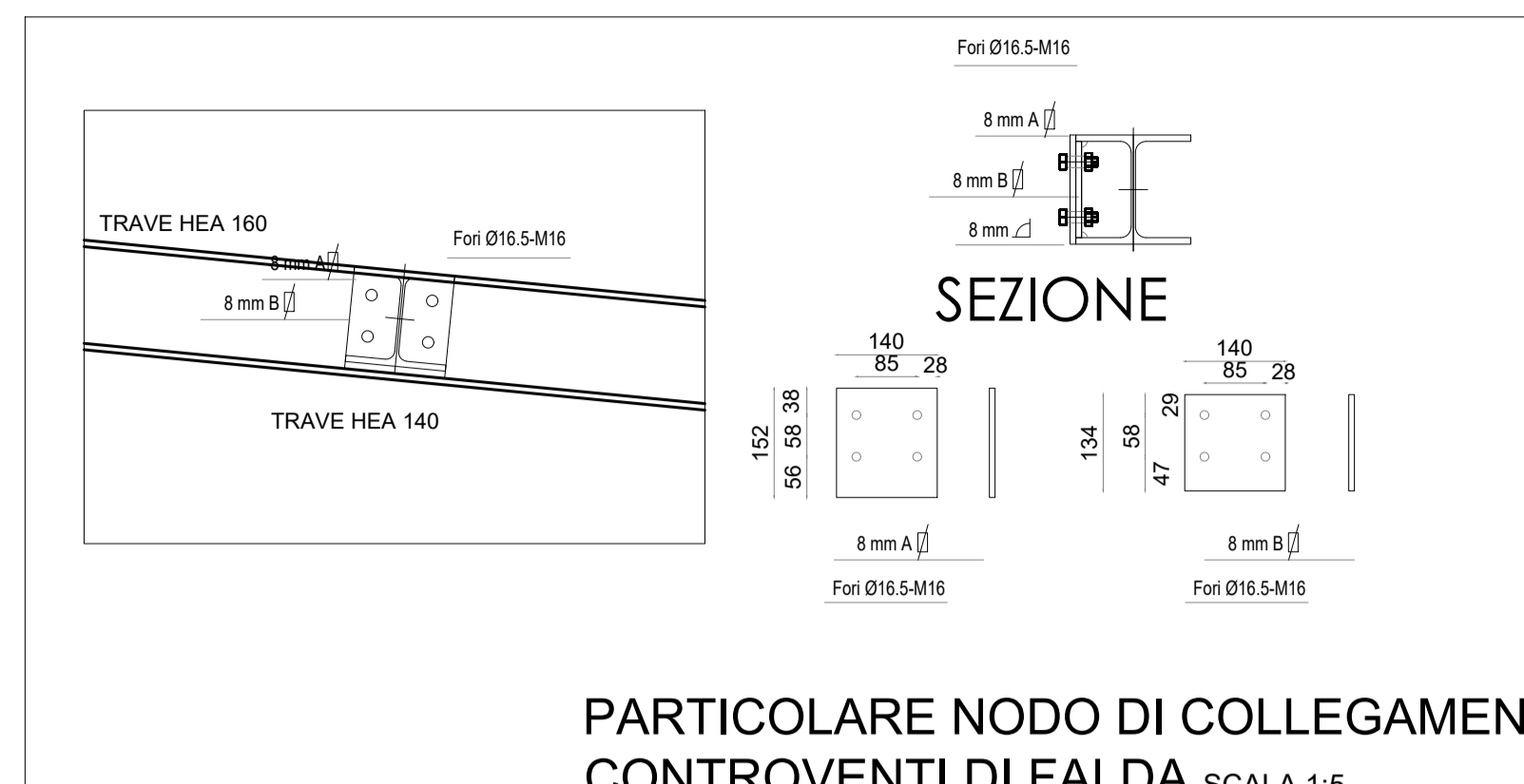

PARTICOLARE 5 Scala 1:10

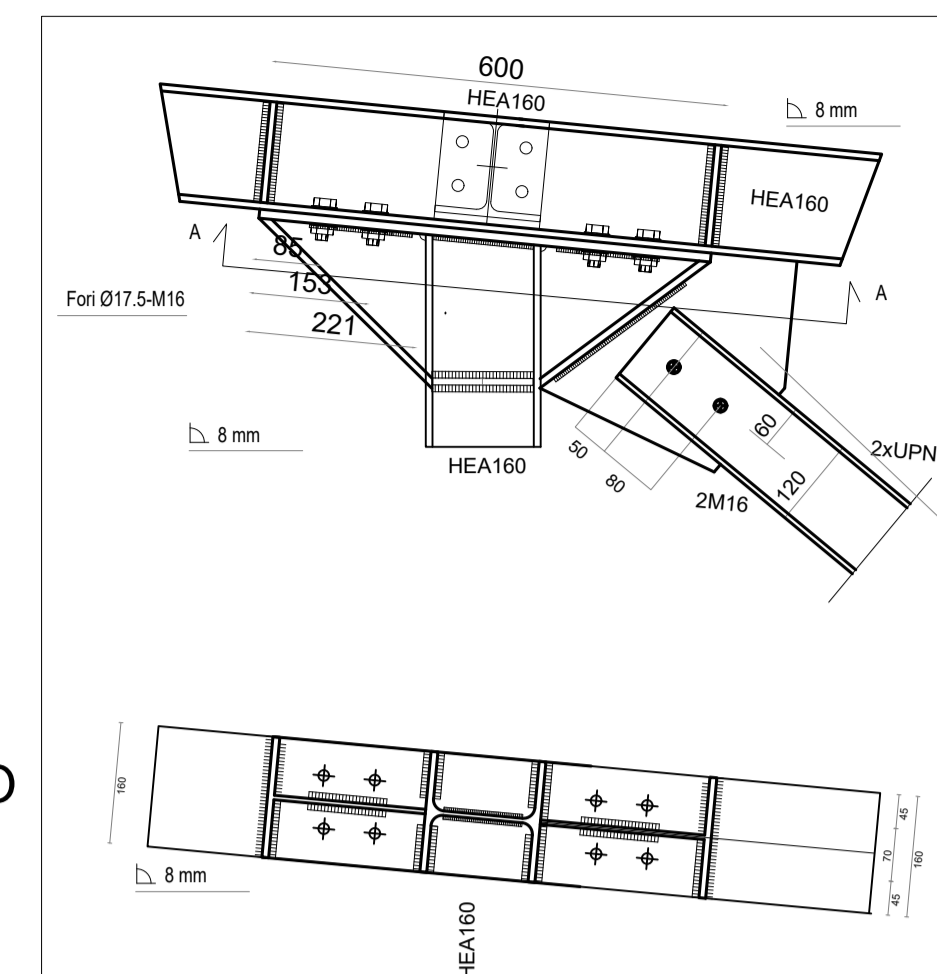

PARTICOLARE 9 scala 1:10

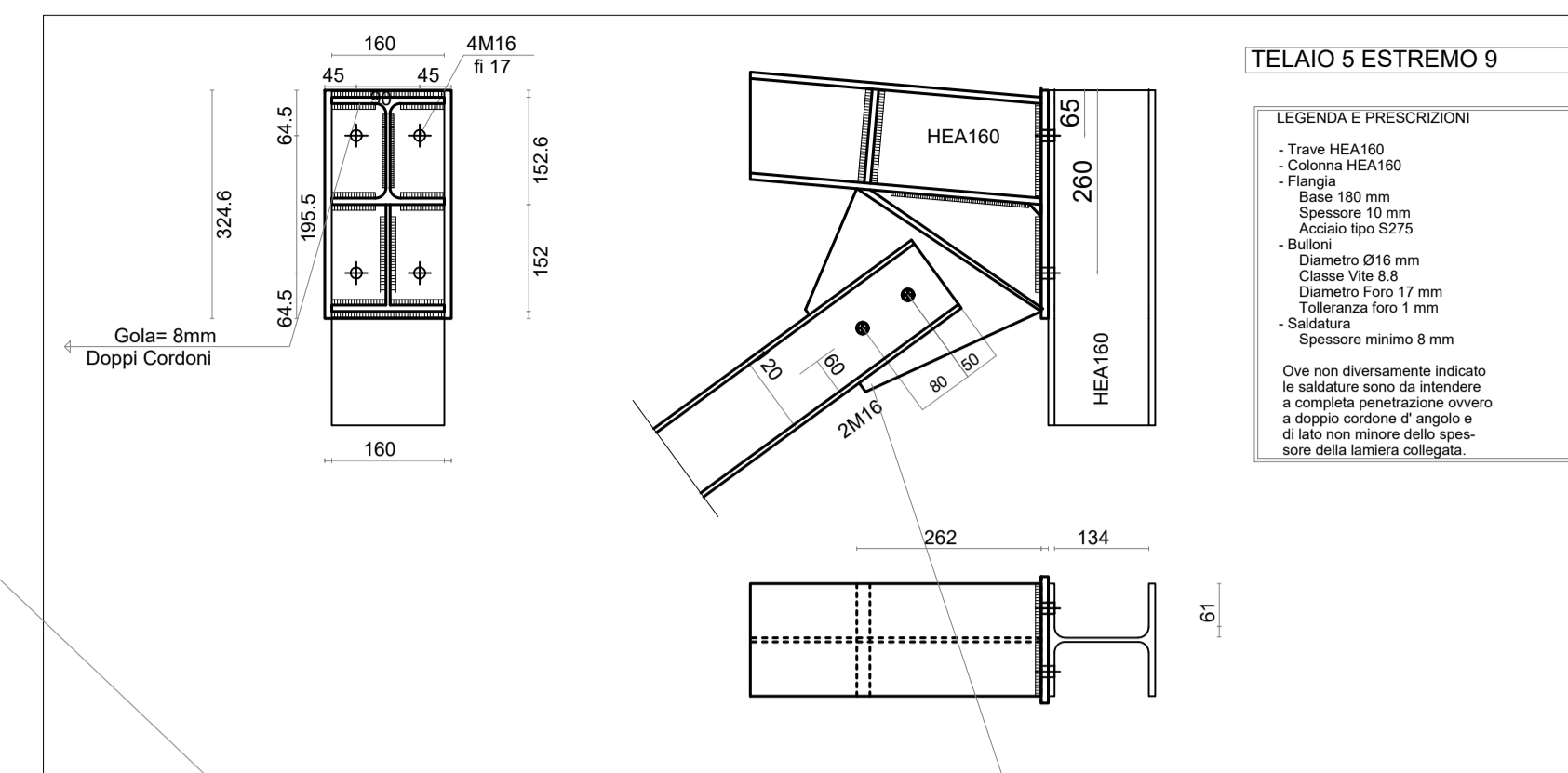

PARTICOLARE NODO DI COLLEGAMENTO CONTROVENTI DI FALDA SCALA 1:5

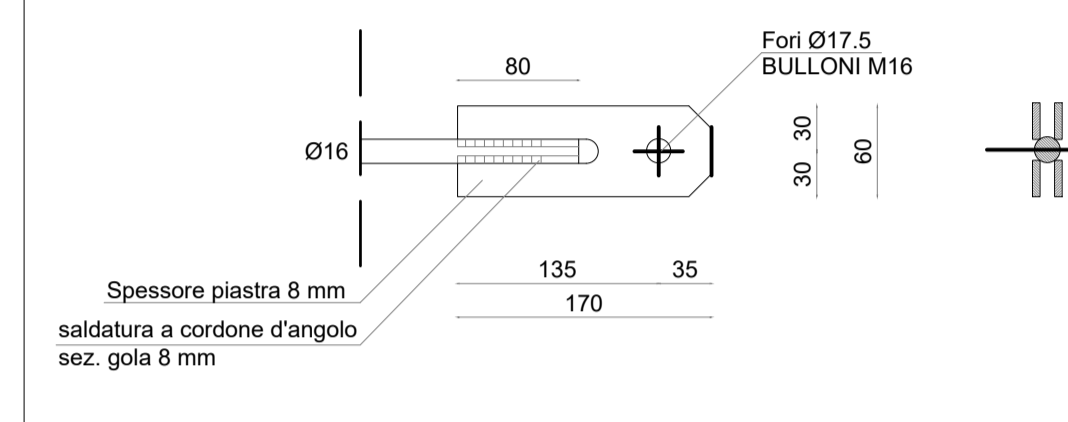

PARTICOLARE 5 SEZ A-A

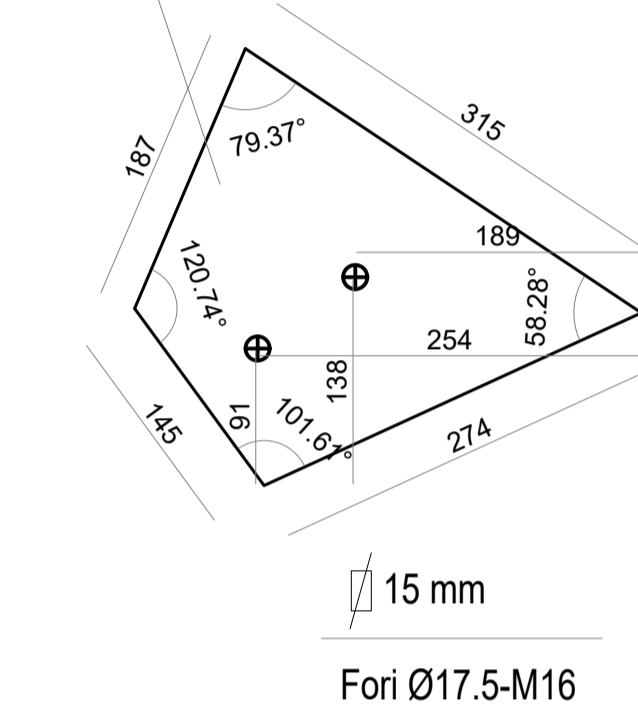
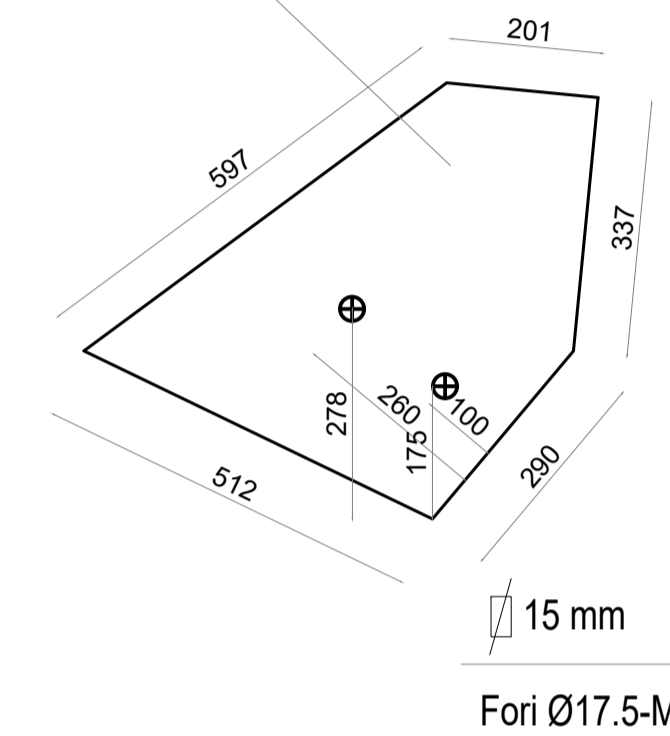
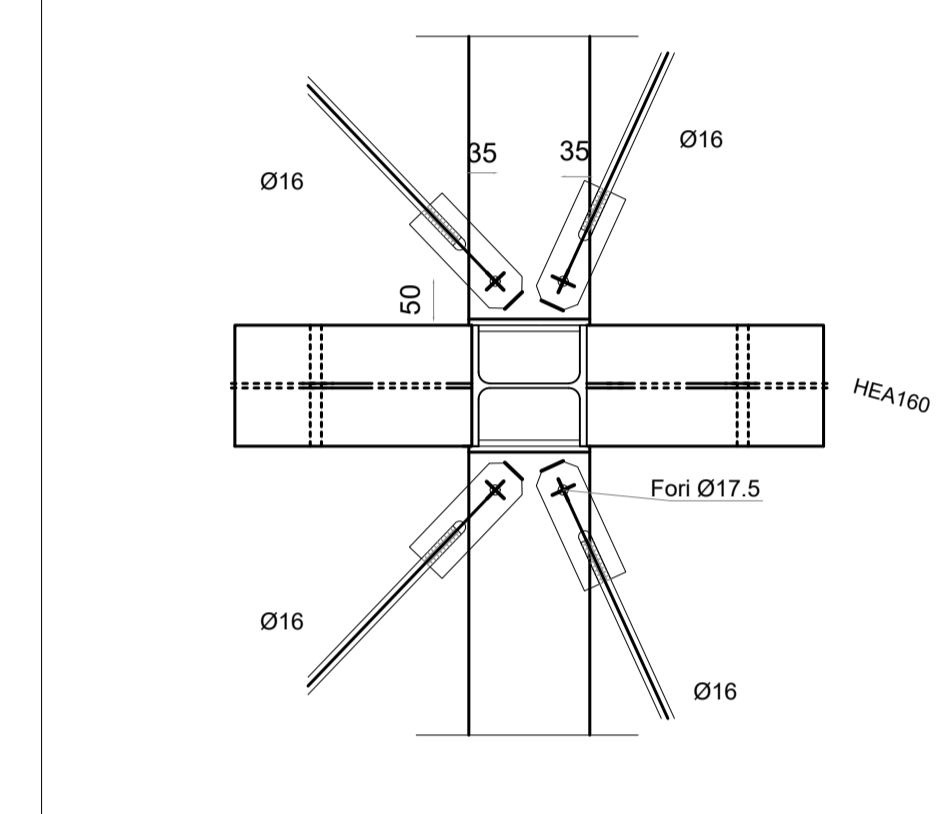

ESECUTIVO TELAIO N.5

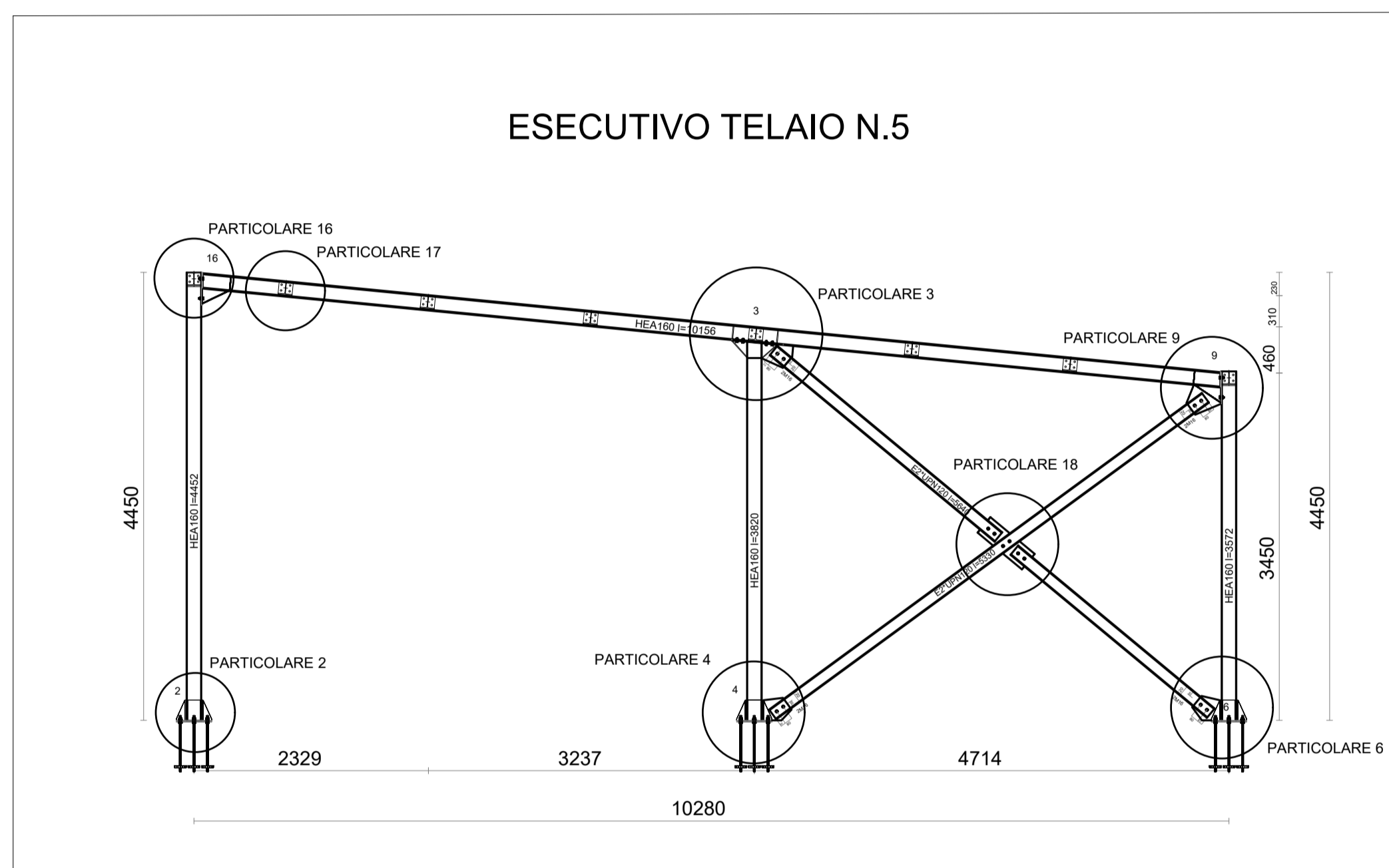

PARTICOLARE 18 Scala 1:5

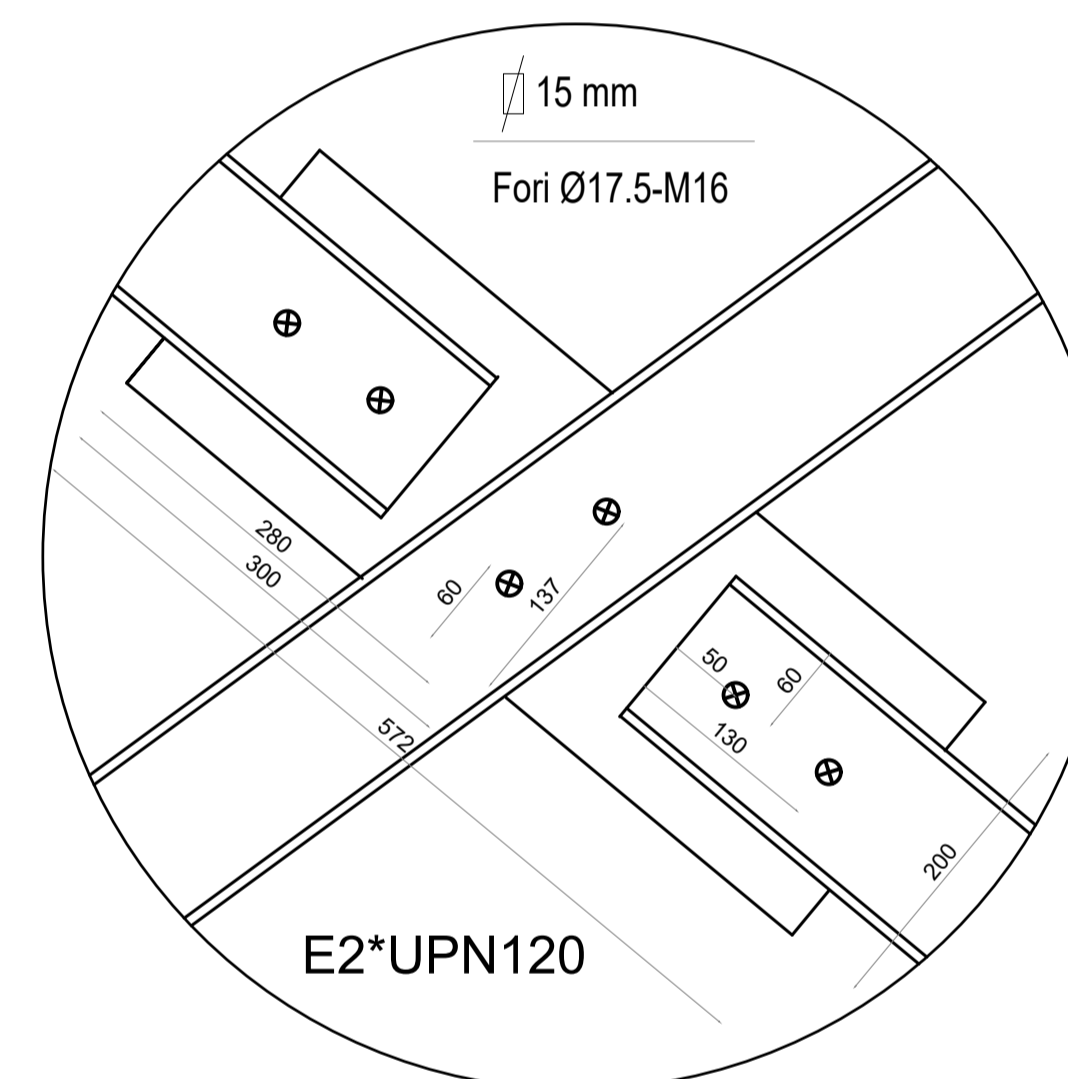

PARTICOLARE 2 scala 1:10

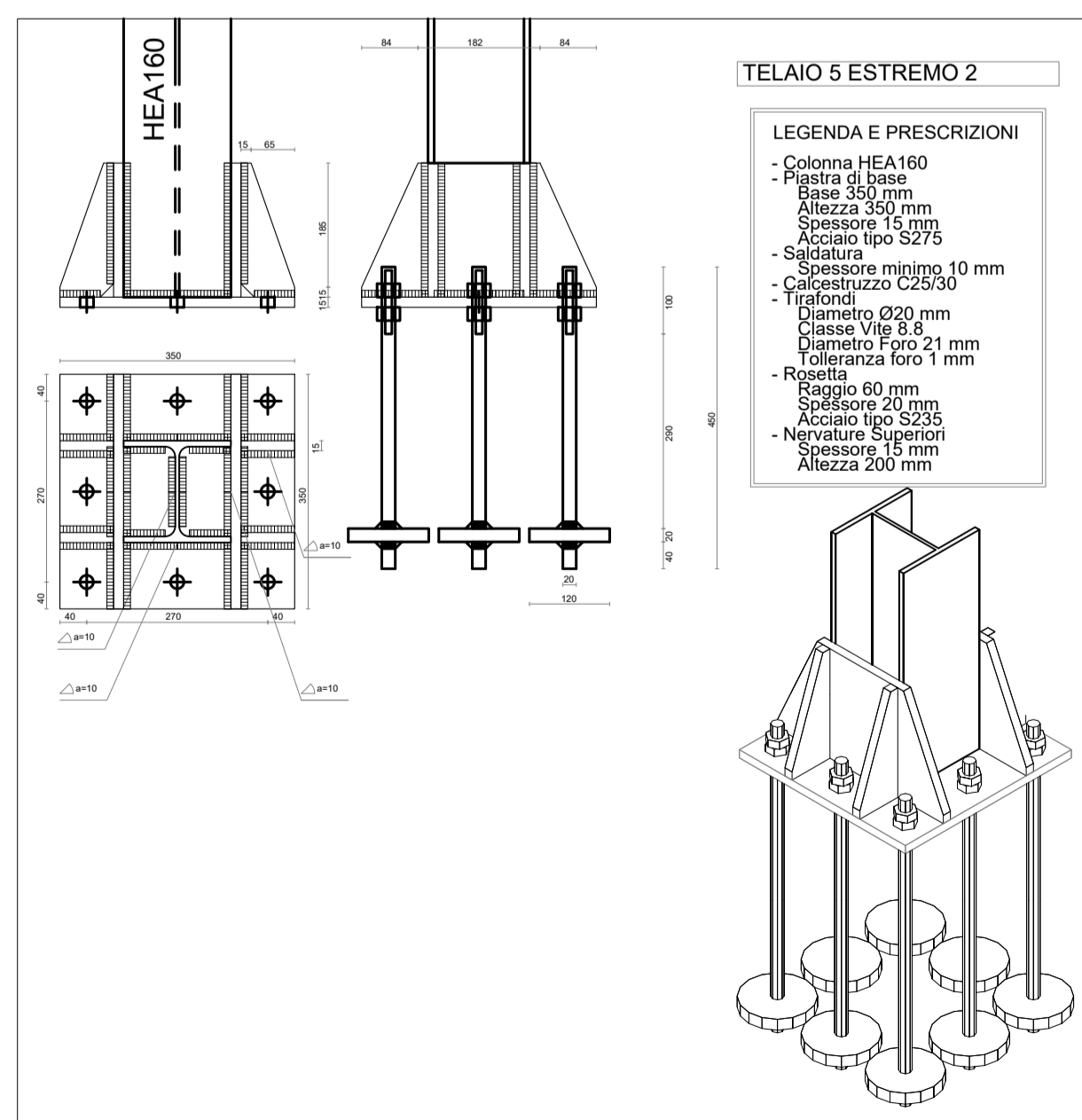

PARTICOLARE 4 scala 1:10

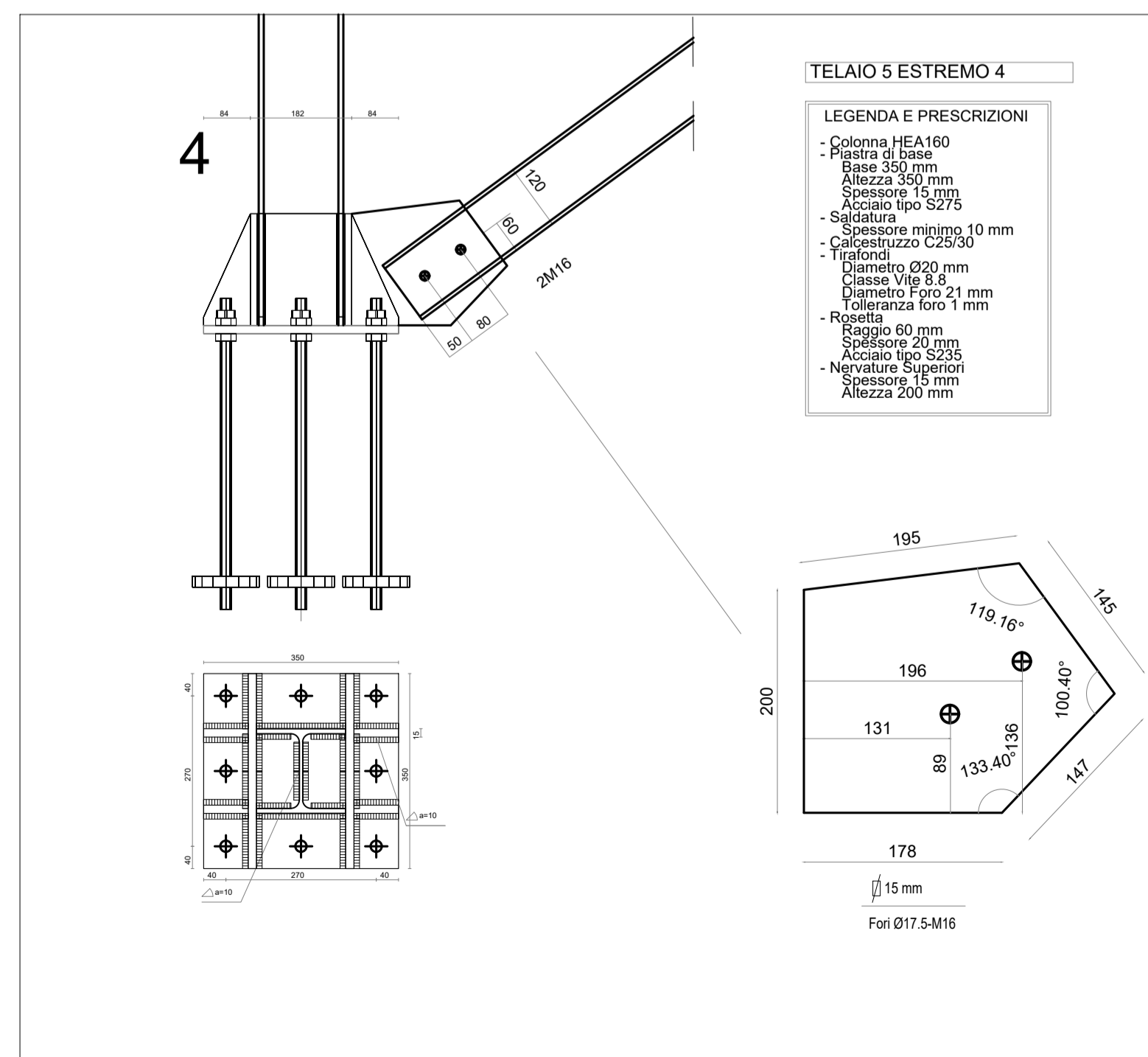

PARTICOLARE 6 scala 1:10

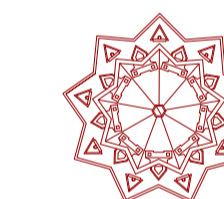
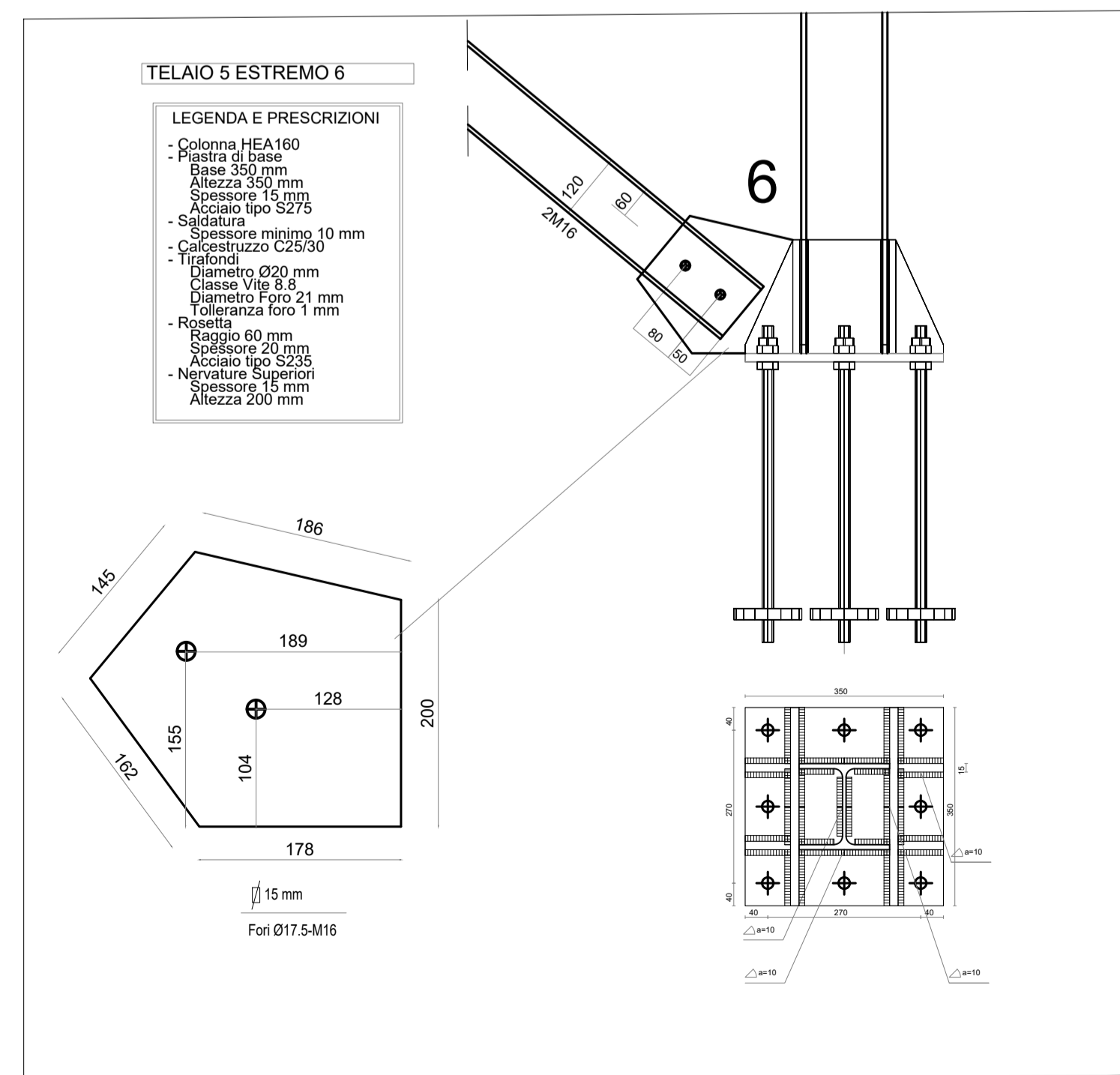

menichelli Architettura Ingegneria
Studio Tecnico di Progettazione - Assisi

committente:

COMUNE DI DERUTA

Comune di Deruta

progetto:

Sisma 24.08.2016 e successivi. Ordinanza del Commissario del Governo per la Ricostruzione nr. 129 del 13/12/2022
Demolizione e ricostruzione ex scuola elementare in frazione Ripabianca

In ASSISI
Fraz. S.Maria degli Angeli, via Raffaello
telefono e fax 075/8042656
E-mail: studiomenichelli@gmail.com

viale Ripabianca, Deruta

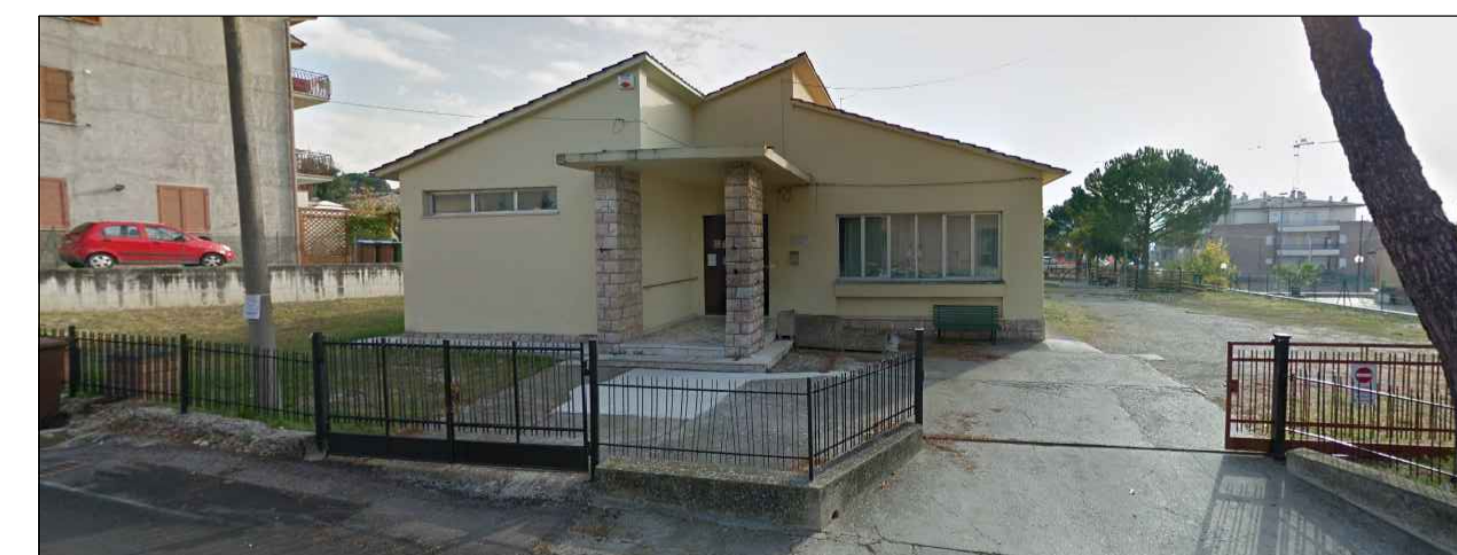

oggetto:

PARTICOLARI COSTRUTTIVI TELAIO IN ACCIAIO N.1

tavola n.

STR04

progettisti:

scala: -
data: ottobre 2023

Ingegnere Giacomo Menichelli

Architetto Simone Menichelli

Geom. Andrea Ranucci

Geol. Simone Sforna

Ing. Lorenzo Binucci

aggiornamenti